

# Dr Brown's™ milestones™

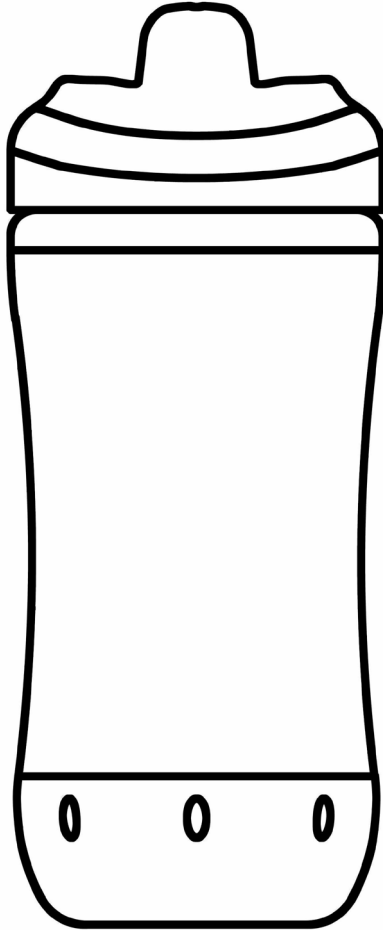

**Sippy Cup**

## ASSEMBLY & USE

Install the valve onto the underside of cap by pressing both sides firmly into place. Valve can sit in either direction.

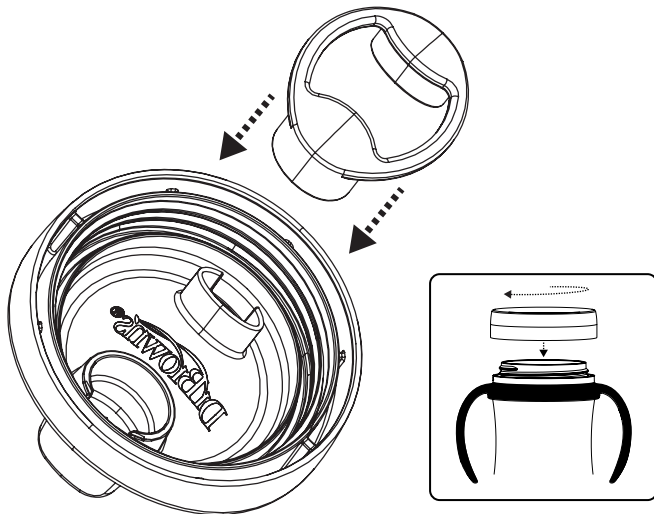

*Read and save these instructions for future use.*

## CLEANING

**Before using, wash in hot soapy water & rinse well – if possible, wash in dishwasher for best results.** Wash cup immediately after every use. Avoid overly aggressive cleaning of any parts to prevent damage to sealing surfaces. Do not boil or microwave to sterilize parts. All parts are dishwasher safe, top rack only.

## For Your Child's Safety and Health

### WARNING!

Always use this product with adult supervision. Continuous and prolonged sucking of fluids will cause tooth decay. Always check food temperature before feeding. Hot or carbonated liquids are not recommended. Due to the risk of hotspots and over-heating, use of a microwave oven is not recommended. Always use transition cup with valve installed. The transition cup will not function properly without it. The spout must be clean and free of obstructions. Keep all components not in use out of the reach of children. Before each use, inspect all components for wear or damage. To prevent a possible choking hazard, test the strength of the valve regularly by pulling hard and checking for cracks or wear. If any component becomes cracked, torn or shows other signs of excessive wear, discontinue use immediately and discard worn or damaged parts. Always use with adult supervision and do not leave child unattended with the cup. Do not allow a child to walk or run while using the cup. Do not leave the product in direct sunlight or heat, store in a dry environment.